

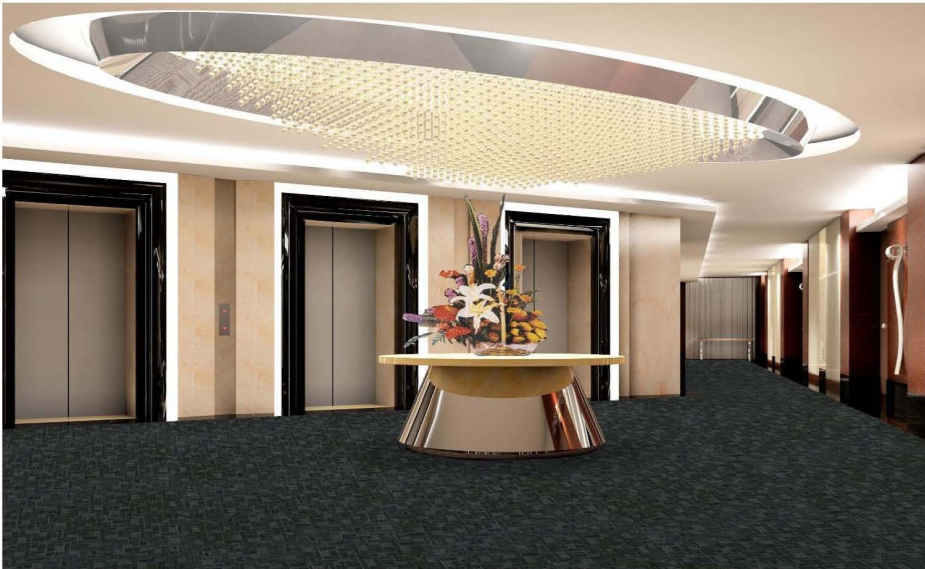

SOFT NUT TP1003



EVENING SKY TP8009

RECOMMENDED INSTALLATION METHODS:

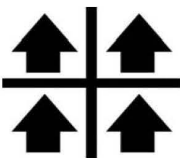

MONOLITHIC

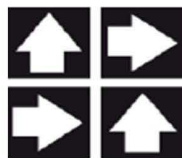

QUARTER-TURN

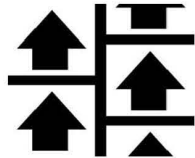

ASHLAR

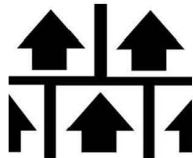

BRICK



OLIVE GARDEN TP3609



SOFT NUT TP1003



REFINED BEIGE TP1001



EVENING SKY TP8009

STYLE NAME:  
CONSTRUCTION:  
YARN:  
DYED METHOD:  
GAUGE:  
PILE HEIGHT:  
TOTAL THICKNESS:  
PILE WEIGHT:  
TOTAL WEIGHT:  
TILE BACKING:  
PRIMARY BACKING CLOTH:  
YARN TREATMENTS:  
ANTI-SOIL, ANTI-OIL TREATMENT:  
TILE SIZE:  
PACKING:  
(\* ) INDENT COLOR MOQ:

**PERFORMANCE**

ELECTROSTATIC PROPENSITY:  
FLAMMABILITY:  
RADIANT PANEL:  
COLORFASTNESS TO LIGHT:  
COLORFASTNESS TO CROCKING :  
SINGAPORE GREEN LABEL:  
SINGAPORE GREEN BUILDING COUNCIL:  
CRI GREEN PLUS LABEL:  
TUFT BIND:  
AACHEN DIMENSIONAL STABILITY:  
ACCELERATED SOILING:  
\* AS IN ALL QUALITY CARPETS, COLOURS ARE SUBJECT TO DYELOT VARIATIONS.

**The Park Ave**  
Cut/Loop piles  
100% Universal Nylon  
100% Solution Dyed  
1/10"  
6 ± 0.3 mm  
9 ± 0.3mm  
1000g/m<sup>2</sup>  
5300 g/m<sup>2</sup>  
PVC with Glass Fiber  
Non-woven Polyester Spunbonded  
3M Scotchgard Permanently Anti Static  
3M Scotchgard  
50cm x 50cm  
16 PCS  
1000 SQM

AATCC 134 1996  
ASTM D 2859 Pill Test  
ASTME 648 (Class 1)  
AATCC 16E  
AATCC 165  
039-025-2280  
039-004-1901  
GLP1879  
ASTM D 1335  
ITTS 004  
ASTM D 6540

